

**VIEWPOINT ESTATE HUNTLY  
STAGE D2  
INTEGRA (VIC) PTY LTD**

## GENERAL NOTES

## A. GENERAL

1. ALL WORK TO BE CARRIED OUT TO GREATER CITY OF BENGO SPECIFICATIONS, STANDARD DRAWINGS AND TO THE SATISFACTION OF COUNCILS SENIOR SURVEILLANCE OFFICER OR HIS REPRESENTATIVE.
2. ALL LEVELS ARE TO AUSTRALIAN HEIGHT DATUM AND ALL COORDINATES ARE TO AUSTRALIAN MAP GRID (LANG).
3. THE LOCATION OF EXISTING SERVICES SHOULD BE DETERMINED BY THE CONTRACTOR PRIOR TO COMMENCING ANY EXCAVATION BY CONTACTING ALL SERVICE AUTHORITIES. ANY EXISTING SERVICES SHOWN ON THESE DRAWINGS ARE OFFERED AS A GUIDE ONLY AND ARE NOT GUARANTEED AS CORRECT.
4. FILL AREAS ARE TO BE STRIPPED OF TOPSOIL, FILLED AND ONLY RE-TOPSOILED ON THE DIRECTION OF THE ENGINEER, TO THE FINAL FILL LEVELS SHOWN ON THE DRAWINGS. ALL FILLING IS TO BE:
  - APPROVED BY THE PROJECT GEOTECHNICAL CONSULTANT.
  - PLACED IN LAYERS NOT EXCEEDING 200MM LOOSE THICKNESS.
  - HUMIDITY CONDITIONED TO WITHIN 85% TO 105% OF OPTIMUM HUMIDITY CONTENT.
  - COMPACTED TO A MINIMUM 90% STANDARD BAY DENSITY RATIO.
  - PLACED UNDER "LEVEL" SUPERVISION IN ACCORDANCE WITH AS 3798-1996.
5. EXISTING DEPRESSIONS & DRAINS TRAVELLING THE SITE ARE TO BE CLEARED OUT AND DESIGNED TO FIRM BASE AND FILLED TO FINISHED SURFACE LEVELS TO THE SPECIFIED COMPACTION STANDARDS.
6. TENTS TO BE RE-ESTABLISHED BY THE LICENSED SURVEYOR IF FOUND TO BE MISSING AT THE COMMENCEMENT OF CONSTRUCTION. THE CONTRACTOR WILL BE RESPONSIBLE FOR CARE AND MAINTENANCE OF TENTS THEREAFTER.
7. POSITION CONDUITS SO THAT A MINIMUM DEPTH BETWEEN TAPPING IS 10M. CONDUITS TO BE LOCATED MIDWAY BETWEEN FENCE LINE & LOT, UNLESS OTHERWISE SHOWN.
8. BEFORE COMMENCING WORK ON EXCAVATIONS IN EXCESS OF 1.5M DEEP, THE REQUIRED NOTICE IS TO BE SENT TO THE VICTORIAN WORKSOWER WORKER IN ACCORDANCE WITH THE MINES ACT, 1998 & 1042 SECTION 80 AND THE OCCUPATIONAL HEALTH AND SAFETY ACT 1985. THIS NOTIFICATION MUST BE RECEIVED BY THE AUTHORITY AT LEAST 3 DAYS PRIOR TO COMMENCING EXCAVATIONS, AND A COPY OF THE NOTIFICATION MUST BE PROVIDED TO THE SUPERINTENDENT.
9. COUNCIL'S REPRESENTATIVE IS TO BE NOTIFIED IN WRITING SEVEN (7) DAYS PRIOR TO THE COMMENCEMENT OF WORKS.
10. NO EXCAVATION WITHIN 5M OF ANY EXISTING TREE WITHOUT APPROVAL OF THE ENGINEER.
11. NO BLASTING IS PERMITTED WITHIN THE GREATER CITY OF BENGO WITHOUT OBTAINING COUNCIL'S SPECIAL DISPENSATION.
12. EXCAVATED MATERIAL, SURPLUS TO FILLING REQUIREMENTS OF THE WORKS SHALL BE REMOVED FROM THE SITE AS SPECIFIED.
13. ALL SURPLUS ROCK, CONCRETE AND BITUMINOUS RUBBLE SHALL BE DISPOSED OFF SITE AS REQUIRED. THE CONTRACTOR SHALL CHECK WITH SUPERINTENDENT WHETHER ANY LARGE ROCKS ARE REQUIRED FOR LANDSCAPE PURPOSES PRIOR TO DISPOSAL. WASTE ITEMS INCLUDING DISCARDED BUILDING MATERIALS AND TREE REMOVAL REMNANTS SHALL BE DISPOSED OFF SITE.
14. NATURE STRIPS AND ALL AREAS OF CUT OUTSIDE ROAD RESERVE TO BE SURFACED WITH 100MM MINIMUM COMPACTED LAYER OF TOPSOIL.
15. ALL EXISTING TREES TO BE REMOVED FROM WITHIN LOTS, MARCHED AND STOCKPILES ON SITE TO BE REACT LOCATED TO BE CONFIRMED WITH SUPERVISING ENGINEER.
16. ALL TREES TO BE RETAINED TO BE PROTECTED BY A TREE PROTECTION ZONE (TPZ). THE TPZ IS TO BE PROVIDED WITH FENCING AS PER DETAIL ON SHEET 12. FENCING RADIUS TO BE THREE TRUNK DIAMETER AT 12m FROM GROUND LEVEL.

### B. ROAD WORKS

4. FOOTPATHS TO BE CONSTRUCTED TO THE GREATER CITY OF BENDIGO STANDARDS.
5. CONSTRUCT LAYBACK SECTION AT VEHICLE CROSSING, REVERSING BAYS AND CAR PARKING BAYS AND PRIAM CROSSING TO THE GREATER CITY OF BENDIGO STANDARDS.
6. ALL CHANGES REFER TO ROAD PAVEMENT CENTRILINES EXCEPT IN COURT HEARDS AND INTERSECTIONS WHERE CHANGES REFER TO BACK OF KERBS.
7. THE CONTRACTOR IS REQUIRED TO CONFINE CONSTRUCTION VEHICLES TO THE ROAD RESERVE AND EASEMENTS, NO DAMAGE CAUSED TO ALLOTMENTS MUST BE MADE GOOD.
8. ALL BATTERS SHALL BE TO THE GREATER CITY OF BENDIGO STANDARDS.
  - CUT IN 1:2 UNLESS OTHERWISE SHOWN.
  - FILL IN 1:2 UNLESS OTHERWISE SHOWN.
9. ALL SET OUT INFORMATION GIVEN IS TO BACK OF KERBS UNLESS OTHERWISE SHOWN.
10. WHERE CRUSHED ROCK IS SHOWN UNDER CONCRETE FOOTPATHS CONSTRUCTED ON FILL, THE CRUSHED ROCK IS TO BE 20MM CLASS 3. WHERE CUT BATTERS ARE STEEPER THAN 1:1 THEY MUST BE HYDRO MALCOLD.
11. SURGRADE MUST BE COMPACTED TO A MINIMUM OF 90% STANDARD MAXIMUM DRY DENSITY (AS3797), WITH THE SURFACE COMPACTED IN ACCORDANCE WITH SCALE C IN VIBRODATAS (TABLE 3.6) USING FINE CRUSHED ROCK AND THE BASE COURSE TO AN AVERAGE OF 90% MINIMUM DRY DENSITY. ALL FILLING TO THE ROAD PAVEMENT AREAS TO BE COMPACTED TO 90% OF STANDARD DRY DENSITY. COMPACTION TESTING TO BE IN ACCORDANCE WITH CITY OF GREATER BENDIGO REQUIREMENTS (REFER TO INFRASTRUCTURE DESIGN MANUAL)
12. ANY BACKFILL WITHIN LHM OF A COUNCIL ASSET (FOOTPATH OR ROAD) IS TO BE FOR FILL MATERIAL IS ACCEPTABLE IF COMPACTED TO ENSURE 95% COMPACTION. COMPACTION TESTING TO BE PERFORMED AT ONE PER CENT OF TRECHEN
13. CONCRETE TO HAVE 20MPA STRENGTH OF 25MPA UNLESS OTHERWISE



PLANNING AND ENVIRONMENT ACT  
GREATER BENDIGO PLANNING SCHEME  
PLAN REFERRED TO IN PLANNING PERMIT  
No: 081546/2012  
L. Connel  
For and on behalf of the City of Greater Bendigo  
Date: 4/7/2014

Sheet Index - Road & Drainage	
Sheet Number	Sheet Title
01	FACE SHEET
02	FACE PLAN 1
03	FACE PLAN 2
04	FACE PLAN 3
05	EXISTING STATE A1 TEMPORARY BASIS
06	ROAD LONGITUDINAL SECTIONS
07	ROAD LONGITUDINAL SECTIONS
08	ROAD LONGITUDINAL SECTIONS
09	ROAD CROSS SECTIONS
10	ROAD CROSS SECTIONS
11	ROAD CROSS SECTIONS
12	ROAD CROSS SECTIONS
13	ROAD CROSS SECTIONS
14	ROAD CROSS SECTIONS
15	ROAD CROSS SECTIONS
16	ROAD CROSS SECTIONS
17	ROAD CROSS SECTIONS
18	INTERSECTION DETAILS
19	INTERSECTION DETAILS
20	DRAINAGE LONGITUDINAL SECTIONS
21	DRAINAGE LONGITUDINAL SECTIONS
22	DRAINAGE LONGITUDINAL SECTIONS
23	DRAINAGE LONGITUDINAL SECTIONS
24	DRAINAGE LONGITUDINAL SECTIONS
25	DRAINAGE PIT SCHEDULE
26	STANDARD DETAILS
27	FILL PLAN
28	FILL PLAN

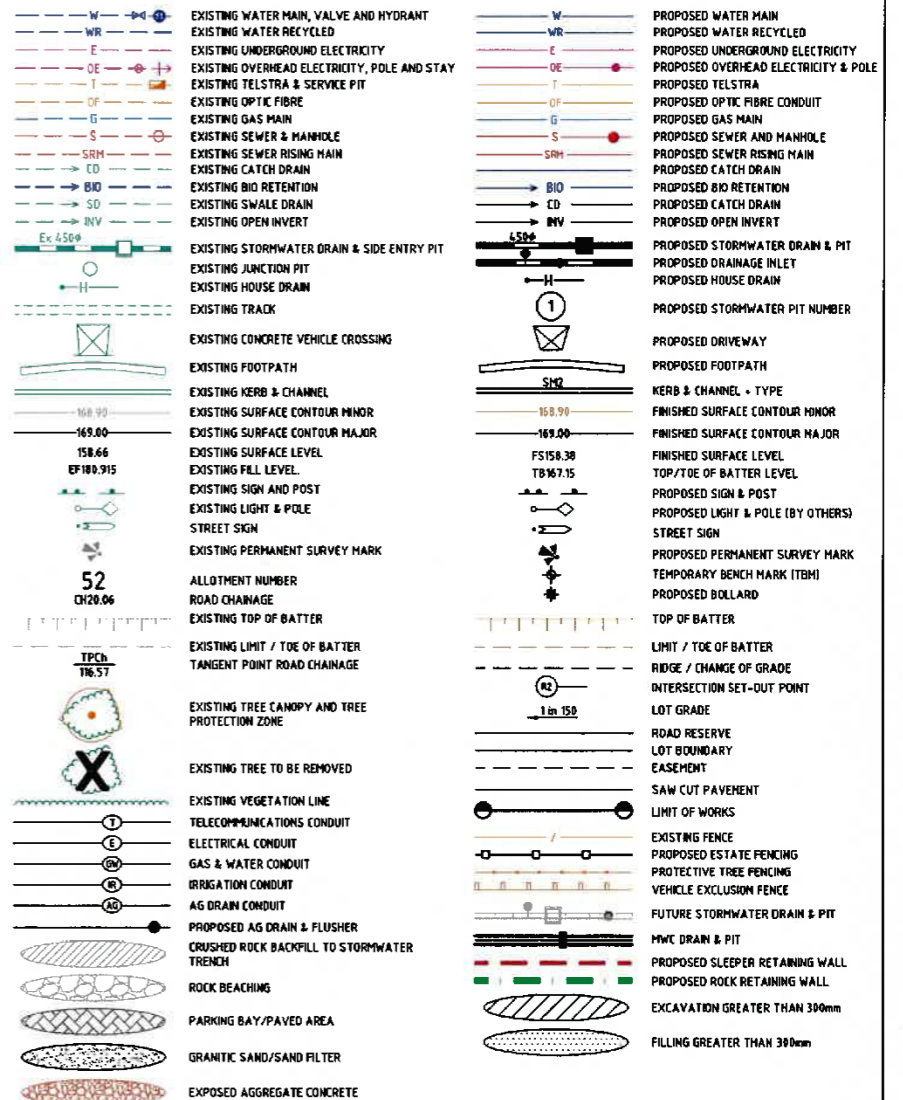

SERVICE LOCATION TABLE																
ROAD NAME	WATER		POTENTIAL FUTURE GAS		ELECTRICITY								OPTIC FIBRE/TELECOMS			
					LV CABLE		HV CONDUIT		LV CABLE BLOCK/OUT		EXISTING OVER-HEAD		PROPOSED UG CABLE		EXISTING UG CABLE	
	SIDE	OFFSET	SIDE	OFFSET	SIDE	OFFSET	OFFSET	OFFSET	SIDE	OFFSET	SIDE	OFFSET	SIDE	OFFSET		
DAISY STREET	N	2.40	N	1.90	S	2.40	-	-	S	1.90	-	-	S	1.90	-	-
EAST ROAD	E	4.275	E	3.875	E	3.225	-	-	E	2.85	-	-	E	2.85	-	-
ASPECT DRIVE	E	2.40	E	1.90	W	2.40	-	-	W	1.90	-	-	W	1.90	-	-
SAWMILL ROAD (EAST OF LOT 145)	S	3.90	S	3.50	S	4.875	5.10	-	S	4.40	-	-	S	4.40	-	-
SAWMILL ROAD (WEST OF LOT 145)	S	3.90	S	3.50	S	4.875	5.10	-	S	4.40	N	-	S	4.40	N	-
SAWMILL ROAD (ADJACENT LOT 146)	S	3.80	S	3.50	S	4.875	5.10	1.00	-	S	4.40	-	S	4.40	-	-

N - NORTH S - SOUTH E - EAST W - WEST

K MEASURED FROM BACK OF KERB

NBN AND ELECTRICITY CABLES TO BE CONSTRUCTED IN A COMMON TRENCH IN ACCORDANCE WITH AUTHORITY STANDARD DRG

**GAS AND WATER MAINS TO BE CONSTRUCTED IN A COMMON TRENCH.**

A	ISSUED TO COUNCIL	C.C.	3/12/13
Rev	Amendments	App'd	Date

file name 142838R1-FS.dwg layout name R1-1  
file location G:\14142838\ACAD (D2)  
plotted by Matthew Rule plot date 31/1/2014 1:41 PM  
© Spire Australia Pty Ltd  
Standard Drawing RDA1 - Version 20120911

**Scale**

**NOT TO SCALE**

<b>Designed</b>	NOV 2013
M.RULE	
<b>Checked</b>	NOV 2013
B.IBBS	
<b>Authorised</b>	NOV 2013
C.CLARKE	

Map Reference VicRoads Ed. 7 600 J7  
Sheet Number 01  
Dwg Status FOR APPROVAL

**spire** ABN 55 050 029 635  
16 Bridge Street Bendigo Victoria 3550 Australia T 61 3 5448 2500  
**spire.com.au**

 CITY OF GREATER  
**BENDIGO**  
ENGINEERING PLANS

- 2 JUL 2014

**APPROVED**

Signed 

**WARNING**  
**BEWARE OF UNDERGROUND/OVERHEAD SERVICES**  
THE LOCATION OF SERVICES ARE APPROXIMATE ONLY  
AND THEIR EXACT POSITION SHOULD BE PROVEN ON  
SITE. NO GUARANTEE IS GIVEN THAT ALL EXISTING  
SERVICES ARE SHOWN. SPECIAL CONSIDERATION  
SHOULD BE GIVEN TO CONSTRUCTION PROCEDURES  
UNDER OVERHEAD ELECTRICITY TRANSMISSION LINES.

**VIEWPOINT ESTATE HUNTLY**  
**STAGE D2**  
**FACE SHEET**

INTEGRA (VIC) PTY LTD  
CITY OF GREATER BENDIGO

Rev A  
Dwg No 142838(D2)R01

PLANNING AND ENVIRONMENT ACT  
GREATER BENDIGO PLANNING SCHEME  
PLAN REFERRED TO IN PLANNING PERMIT  
No: DS157612012  
L. Camilleri  
For and on behalf of the City of Greater Bendigo  
Date: 4/7/2014

CITY OF GREATER  
**BENDIGO**  
ENGINEERING PLANS  
- 2 JUL 2014  
**APPROVED**  
Signed [Signature]

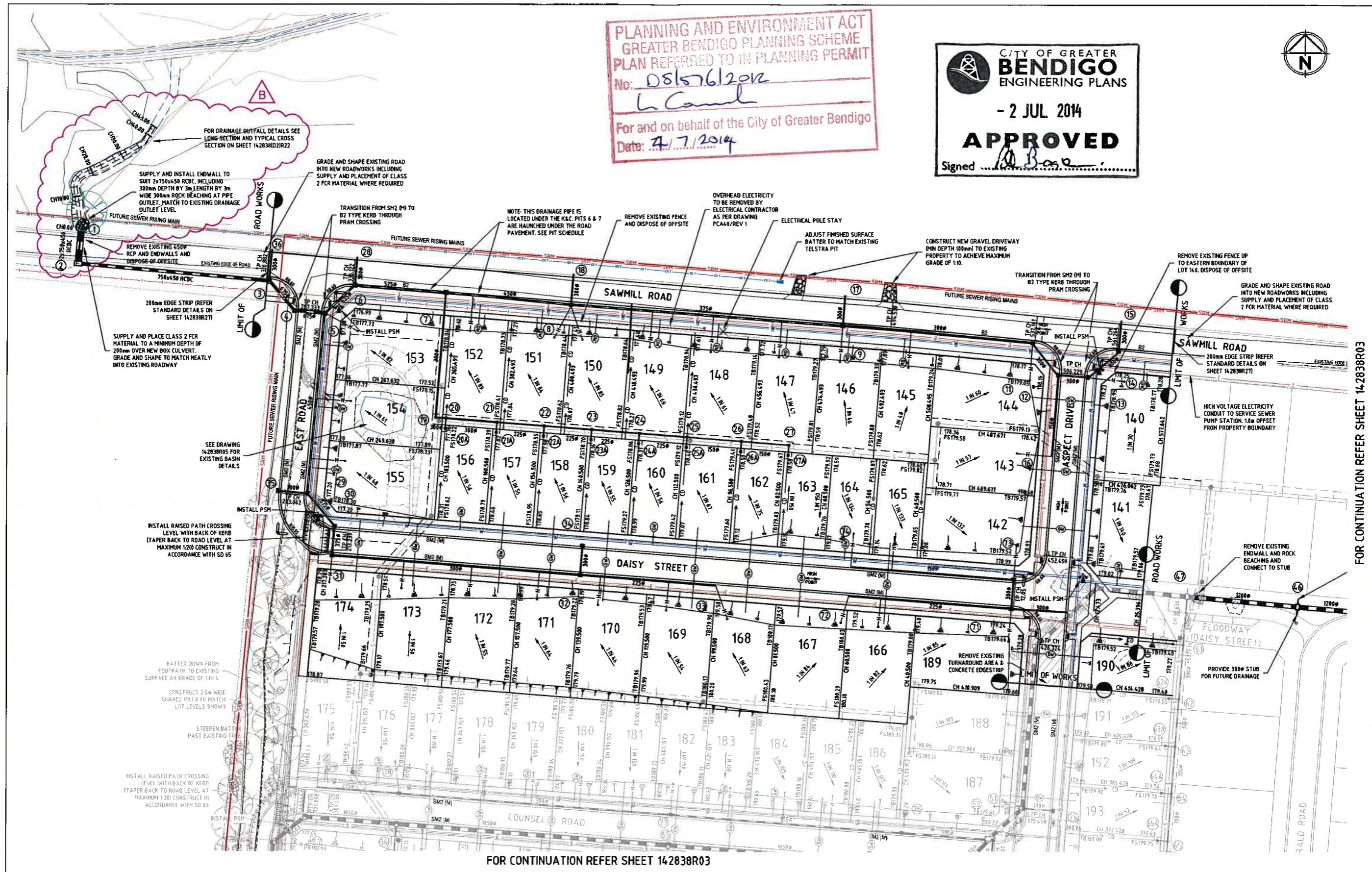

Rev	Amendments	App'd	Date
B	ADDED SAWMILL ROAD DRAINAGE OUTFALL DETAILS	C.C.	31/01/14
A	ISSUED TO COUNCIL	C.C.	31/12/13

File name 142838R2-FP.dwg layout name R2-1  
File location G:\142838\ACAD\021  
Plotted by Matthew Rule plot date 31/1/2014 1:41 PM  
© Spiire Australia Pty Ltd  
Standard Drawing RDA1 - Version 20120911

Scale 1:500 A1  
Horizontal 1:500  
Vertical 1:500

Designed NOV 2013  
M.RULE  
Checked NOV 2013  
B.I.BBS  
Authorised NOV 2013  
C.CLARKE

Map Reference VicRoads Ed. 7 600 J7  
Sheet Number 02  
Drg Status FOR APPROVAL

spiire ABN 55 050 029 635  
16 Bridge Street Bendigo Victoria 3550 Australia T 61 3 5448 2500  
spiire.com.au

**spiire**  
Innovation in  
Infrastructure

VIEWPOINT ESTATE HUNTLY  
STAGE D2  
FACE PLAN 1

INTEGRA (VIC) PTY LTD  
CITY OF GREATER BENDIGO

Rev B  
Drg No 142838(D2)R02

FOR CONTINUATION REFER SHEET 142838R02

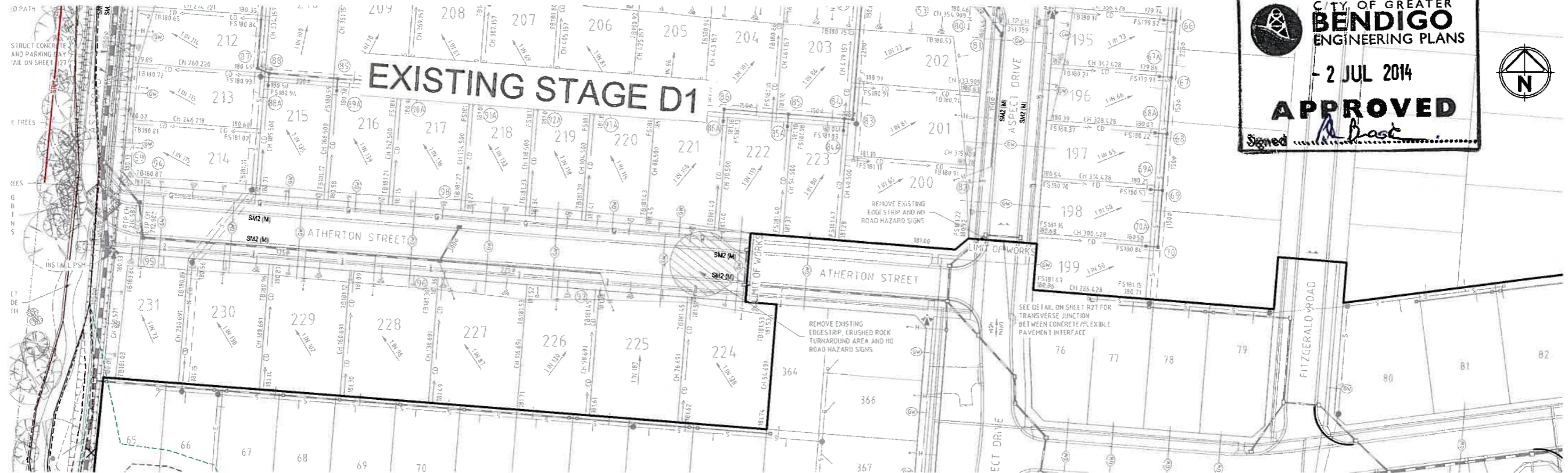
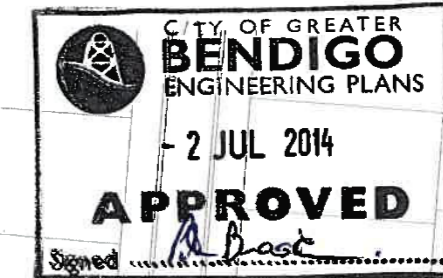

FOR CONTINUATION REFER SHEET 142838R03

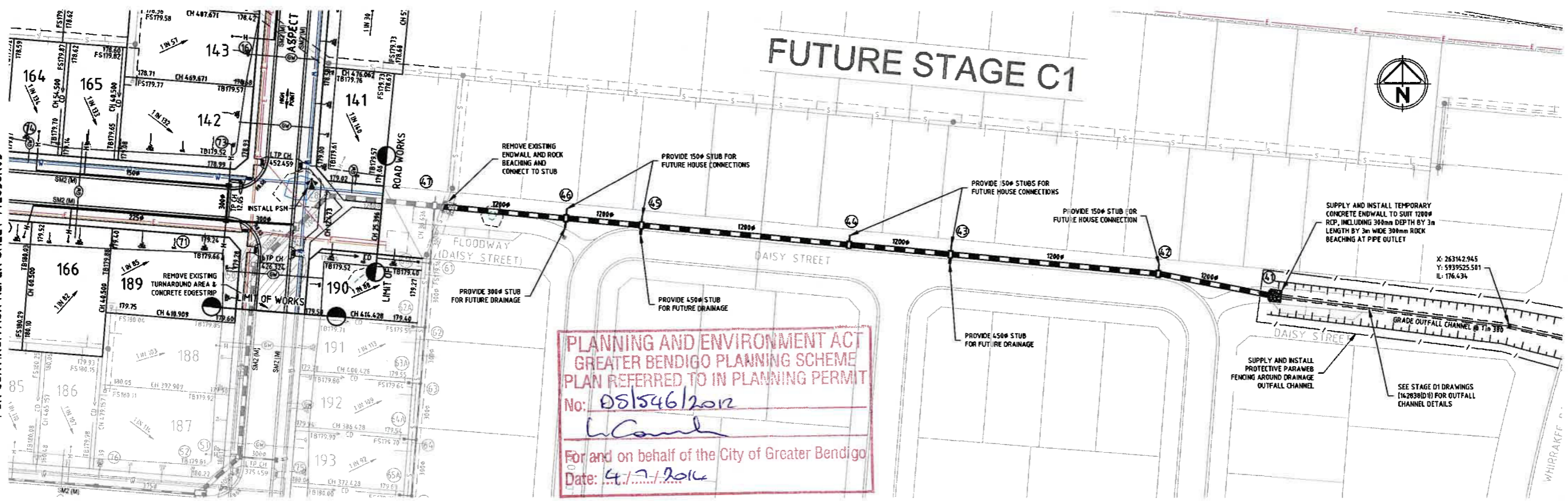

FOR CONTINUATION REFER SHEET 142838R04

PLANNING AND ENVIRONMENT ACT  
 GREATER BENDIGO PLANNING SCHEME  
 PLAN REFERRED TO IN PLANNING PERMIT  
 No: 081546/2012  
 L. Camilleri  
 For and on behalf of the City of Greater Bendigo  
 Date: 4/7/2014

Rev	Amendments	App'd	Date
A	ISSUED TO COUNCIL	C.G.	3/12/13

File name 142838R2-FP.dwg layout name R2-2  
 File location G:\142838\ACAD\ (D2)  
 Plotted by Matthew Rule plot date 31/12/2014 1:41 PM  
 © Spiire Australia Pty Ltd  
 Standard Drawing RDA1 - Version 20120811

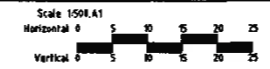

Designed NOV 2013  
 M.RULE  
 Checked NOV 2013  
 B.IBBS  
 Authorised NOV 2013  
 C.CLARKE

Map Reference VicRoads Ed. 7 600 J7  
 Sheet Number 03  
 Drg Status FOR APPROVAL  
 spiire ABN 55 050 029 635  
 16 Bridge Street Bendigo Victoria 3650 Australia T 61 3 5448 2500  
 spiire.com.au



VIEWPOINT ESTATE HUNTLY  
 STAGE D2  
 FACE PLAN 2  
 INTEGRA (VIC) PTY LTD  
 CITY OF GREATER BENDIGO  
 Rev A  
 Drg No 142838(D2)R03





CITY OF GREATER  
**BENDIGO**  
ENGINEERING PLANS

- 2 JUL 2014  
**APPROVED**  
Signed *[Signature]*

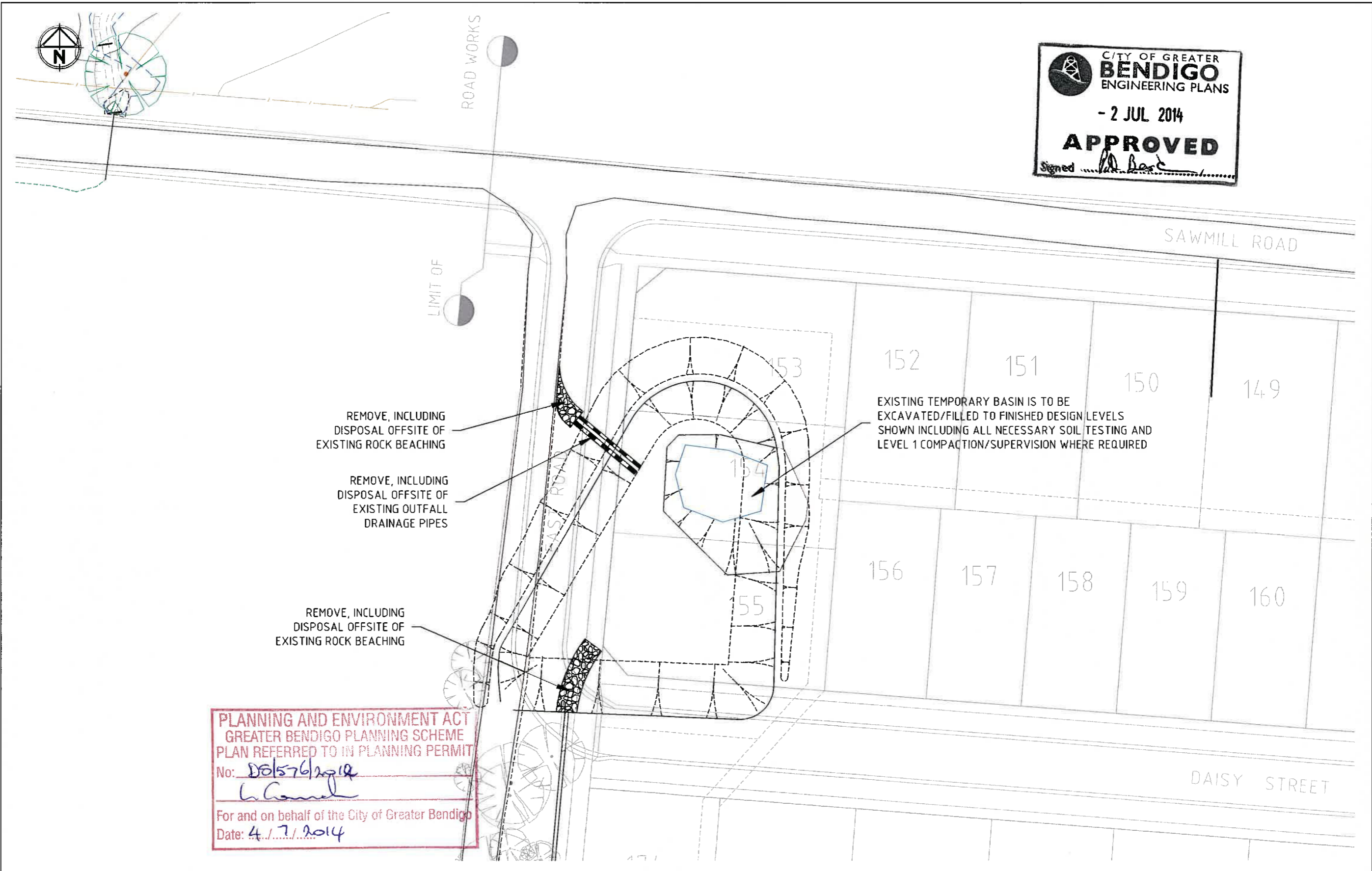

PLANNING AND ENVIRONMENT ACT  
GREATER BENDIGO PLANNING SCHEME  
PLAN REFERRED TO IN PLANNING PERMIT  
No: *D0157612012*  
*[Signature]*  
For and on behalf of the City of Greater Bendigo  
Date: *4/7/2014*

Rev	Amendments	App'd	Date
A	ISSUED TO COUNCIL	C.C	31/12/13

file name 142838R2-FP.dwg layout name R2-4  
file location G:\142838\BACAD (D2)  
plotted by Matthew Rule plot date 31/12/2014 1:41 PM  
© Spiire Australia Pty Ltd  
Standard Drawing RDA1 - Version 20120911

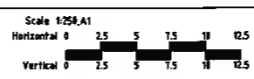

Designed NOV 2013  
M.RULE  
Checked NOV 2013  
B.IBBS  
Authorised NOV 2013  
C.CLARKE

Map Reference VicRoads Ed. 7 600 J7  
Sheet Number 05  
Drg Status FOR APPROVAL

**spiire** ABN 55 050 029 635  
16 Bridge Street Bendigo Victoria 3550 Australia T 61 3 5448 2500  
**spiire.com.au**



**VIEWPOINT ESTATE HUNTLY**  
**STAGE D2**  
**FACE PLAN**  
EXISTING STAGE A1 TEMPORARY BASIN  
INTEGRA (VIC) PTY LTD  
CITY OF GREATER BENDIGO  
Rev **A**  
Drg No **142838(D2)R05**

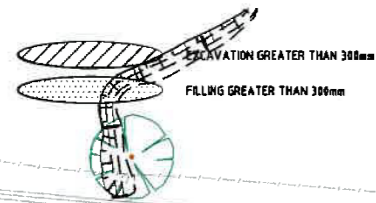

CITY OF GREATER  
**BENDIGO**  
ENGINEERING PLANS  
- 2 JUL 2014  
**APPROVED**  
Signed: *[Signature]*

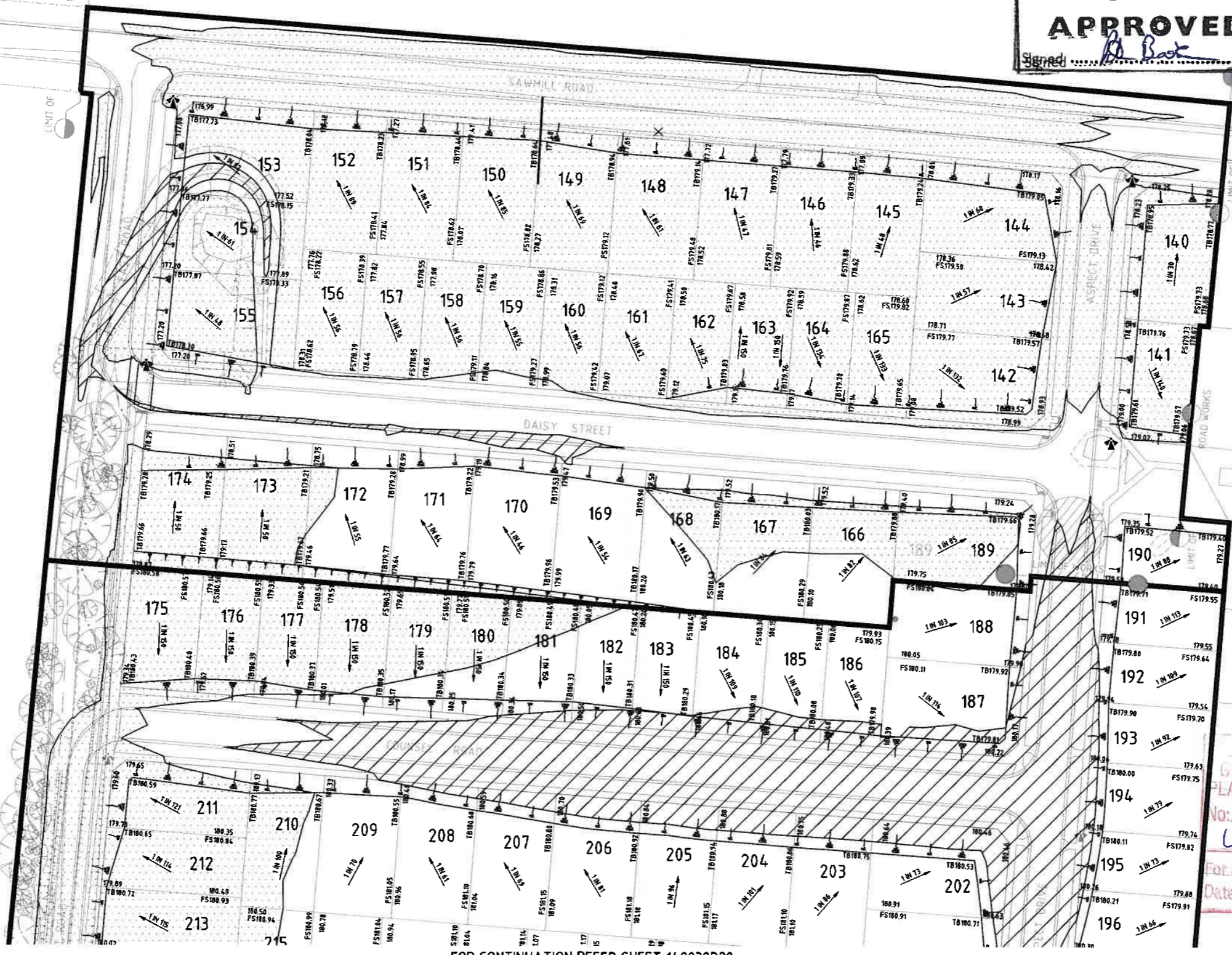

PLANNING AND ENVIRONMENT ACT  
GREATER BENDIGO PLANNING SCHEME  
PLAN REFERRED TO IN PLANNING PERMIT  
No: *DS1546/2012*  
*L. Carroll*  
For and on behalf of the City of Greater Bendigo  
Date: *4/7/2014*

Rev	Amendments	App'd	Date
A	ISSUED TO COUNCIL	C.C.	3/12/13

File name: 142838R2-FILL PLAN.dwg layout name: R2-1  
File location: G:\142838\ACAD (D2)  
Plotted by: Matthew Rule plot date: 31/12/2014 1:43 PM  
© Spiire Australia Pty Ltd  
Standard Drawing RDA1 - Version 20120911



Designed: NOV 2013  
M. RULE  
Checked: NOV 2013  
B. JIBBS  
Authorised: NOV 2013  
C. CLARKE  
Map Reference: VicRoads Ed. 7 600 J7  
Sheet Number: 27  
Dry Status: FOR APPROVAL

spiire ABN 55 050 029 835  
10 Bridge Street Bendigo Victoria 3550 Australia T 61 3 5448 2500  
spiire.com.au



**VIEWPOINT ESTATE HUNTLY  
STAGE D2  
FILL PLAN**  
INTEGRA (VIC) PTY LTD  
CITY OF GREATER BENDIGO  
Rev A  
Drg No 142838(D2)R27

EXCAVATION GREATER THAN 300mm  
FILLING GREATER THAN 300mm

FOR CONTINUATION REFER SHEET 142838R28



PLANNING AND ENVIRONMENT ACT  
GREATER BENDIGO PLANNING SCHEME  
PLAN REFERRED TO IN PLANNING PERMIT  
No: DS1546/2012  
L. Conlon  
For and on behalf of the City of Greater Bendigo  
Date: 4/7/2014

CITY OF GREATER  
**BENDIGO**  
ENGINEERING PLANS  
- 2 JUL 2014  
**APPROVED**  
Signed: [Signature]

Rev	Amendments	App'd	Date
A	ISSUED TO COUNCIL	C.C	3/12/13

File name 142838R2-FILL PLAN.dwg layout name R8-2  
File location G:\14\142838\ACAD (D2)  
plotted by Matthew Rule plot date 31/1/2014 1:43 PM  
© Spiire Australia Pty Ltd  
Standard Drawing RDA1 - Version 20120911



Designed NOV 2013  
MRULE  
Checked NOV 2013  
B.I.BBS  
Authorised NOV 2013  
C. CLARKE

Map Reference VicRoads Ed 7 600 J7  
Sheet Number 28  
Drg Status FOR APPROVAL

spiire ABN 56 050 029 635  
16 Bridge Street Bendigo Victoria 3550 Australia T 61 3 5448 2500  
spiire.com.au

**spiire**  
Innovation in  
Infrastructure

VIEWPOINT ESTATE HUNTLY  
STAGE D2  
FILL PLAN  
INTEGRA (VIC) PTY LTD  
CITY OF GREATER BENDIGO  
Rev A  
Drg No 142838(D2)R28